

THIS DRAWING IS COPYRIGHT, AND REMAINS THE PROPERTY OF HTC ARCHITECTS. IT MUST NOT BE REPRODUCED, USED, DISCLOSED OR TRANSMITTED TO THIRD PARTIES IN ANY FORM, IN WHOLE OR IN PART, WITHOUT PRIOR WRITTEN PERMISSION.

DO NOT SCALE!  
ALL DIMENSIONS SHOULD BE CHECKED ON SITE BEFORE WORK COMMENCES

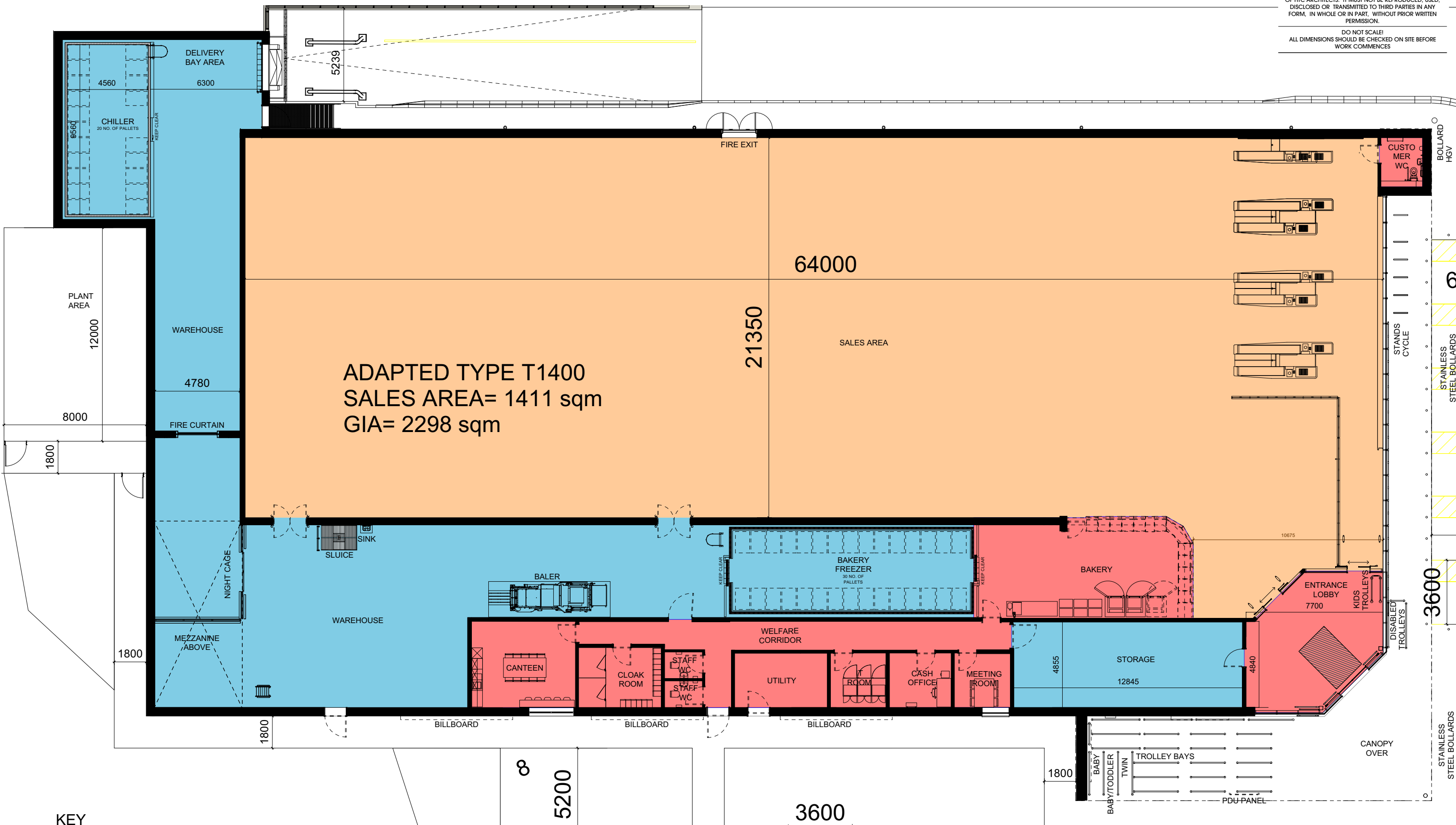

- KEY**
- SALES AREA (1411m<sup>2</sup>)
  - WAREHOUSE AREA (609m<sup>2</sup>)
  - ANCILLARY AREA (278m<sup>2</sup>)
- GIA 2298m<sup>2</sup>  
GEA (EX. CANOPY) 2399m<sup>2</sup>  
GEA (IN. CANOPY) 2575m<sup>2</sup>

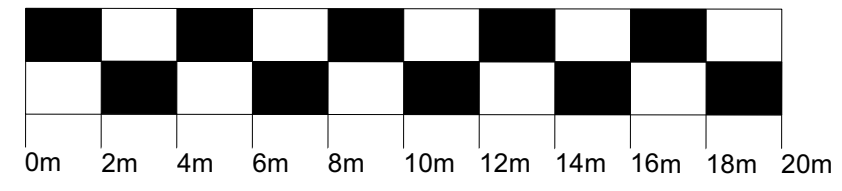

Rev.	Date	Description	Drawn

**htcarchitects**

York Place Studio  
8 Britannia Street  
Leeds  
LS1 2DZ

T: (0113) 244 3457  
W: www.htcarchitects.co.uk  
E: info@htcarchitects.co.uk

client  
Lidl GB Ltd

project  
Briton Ferry



drawing title  
Proposed Areas Plan

date December 2021  
status Planning  
scale 1:200 @ A3  
drawn DS checked LS  
job no. 2782 dwg no. P106 Rev. /