

THIS DRAWING IS COPYRIGHT, AND REMAINS THE PROPERTY OF HTC ARCHITECTS. IT MUST NOT BE REPRODUCED, USED, DISCLOSED OR TRANSMITTED TO THIRD PARTIES IN ANY FORM, IN WHOLE OR IN PART, WITHOUT PRIOR WRITTEN PERMISSION.

DO NOT SCALE!  
ALL DIMENSIONS SHOULD BE CHECKED ON SITE BEFORE WORK COMMENCES

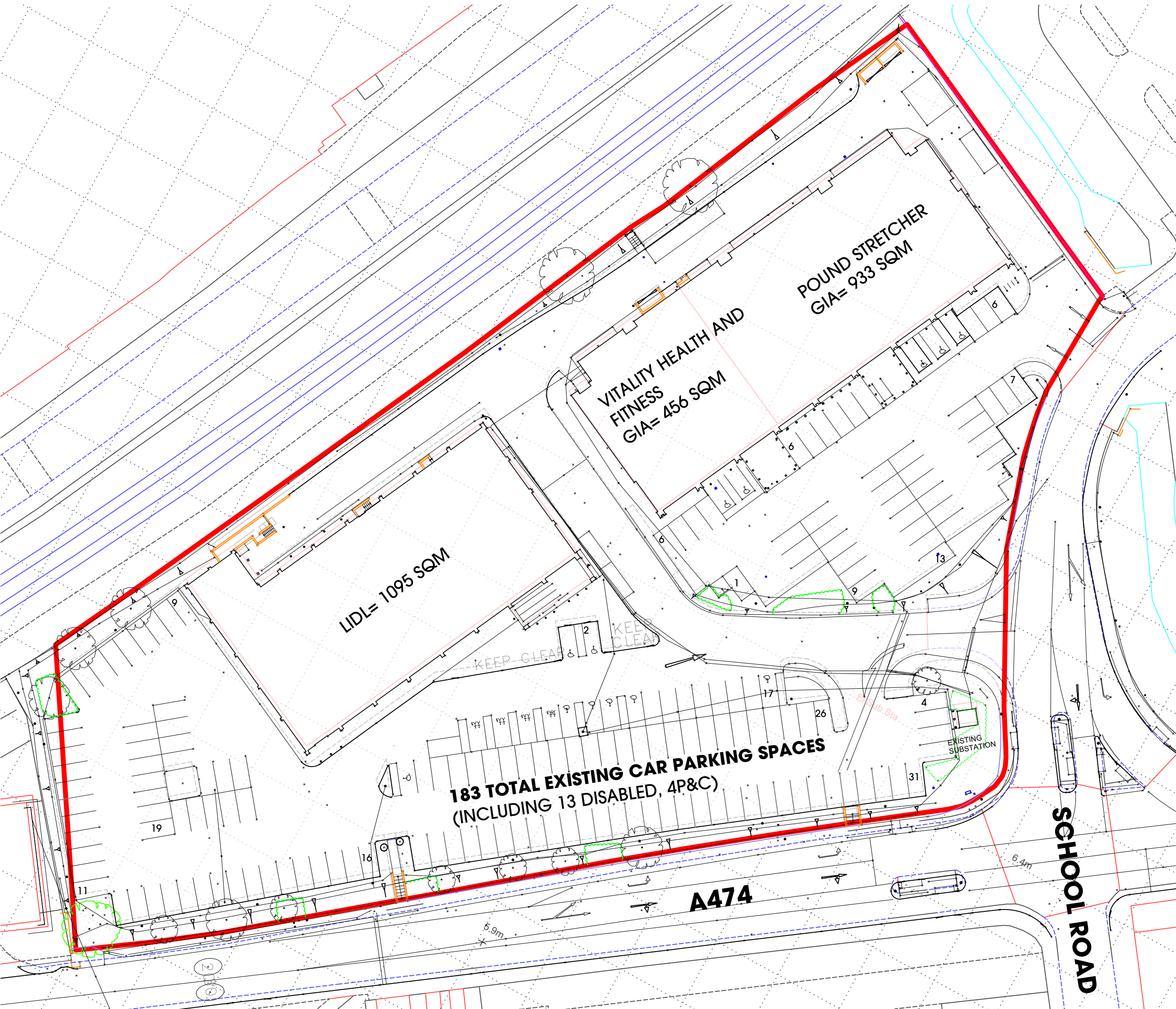
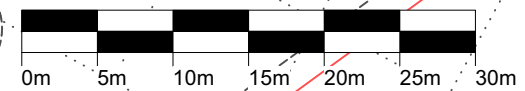

LIDL= 1095 SQM

VITALITY HEALTH AND FITNESS  
GIA= 456 SQM

POUND STRETCHER  
GIA= 933 SQM

183 TOTAL EXISTING CAR PARKING SPACES  
(INCLUDING 13 DISABLED, 4P&C)

A474

SCHOOL ROAD

| Rev. | Date | Description | Drawn |
|------|------|-------------|-------|
|------|------|-------------|-------|

**htcarchitects**

York Place Studio  
8 Britannia Street  
Leeds  
LS1 2DZ  
T: (0113) 244 3457  
W: www.htcarchitects.co.uk  
E: info@htcarchitects.co.uk

client  
Lidl GB Ltd



project  
Briton Ferry

drawing title  
Existing Site Plan

|         |               |         |      |      |   |
|---------|---------------|---------|------|------|---|
| date    | December 2021 |         |      |      |   |
| status  | Planning      |         |      |      |   |
| scale   | 1:500 @ A3    |         |      |      |   |
| drawn   | DS            | checked | LS   |      |   |
| job no. | 2782          | dwg no. | P407 | Rev. | / |