

THIS DRAWING IS COPYRIGHT, AND REMAINS THE PROPERTY OF  
HTC ARCHITECTS. IT MUST NOT BE REPRODUCED, USED,  
DISCLOSED OR TRANSMITTED TO THIRD PARTIES IN ANY FORM, IN  
WHOLE OR IN PART, WITHOUT PRIOR WRITTEN PERMISSION.

DO NOT SCALE!  
ALL DIMENSIONS SHOULD BE CHECKED ON SITE BEFORE  
WORK COMMENCES

BASED ON BOYES REES ARCHITECTS PDF DRAWING:  
'6020-BRA-012000 LIDL NEATH BRITON FERRY SITE PLAN OPTION B  
REV5' DATED NOVEMBER 2017

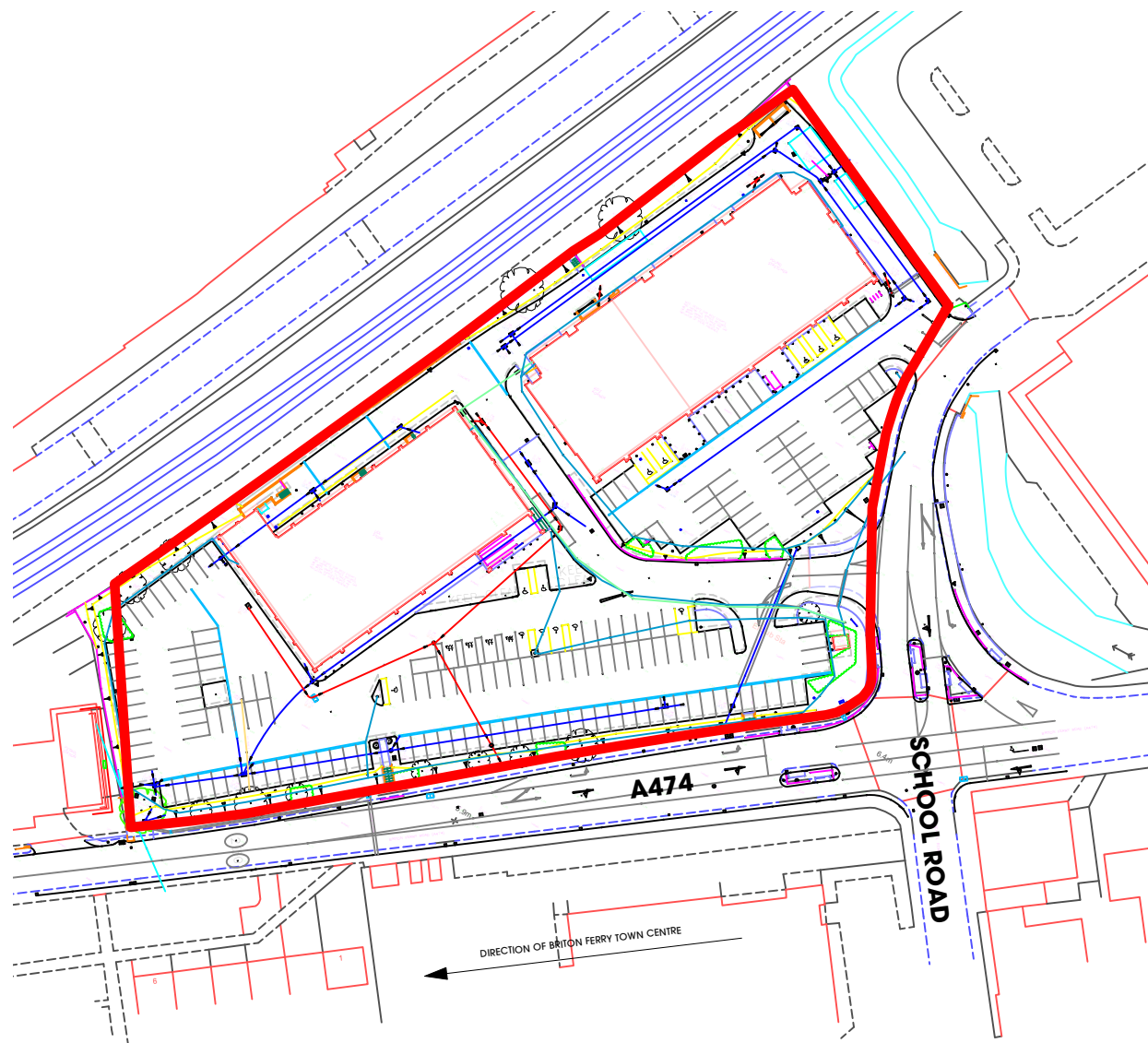
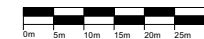

Rev.	Date	Description	Drawn

**htcarchitects**

York Place Studio  
8 Britannia Street  
Leeds  
LS1 2DZ

T: (0113) 244 3457  
W: [www.htcarchitects.co.uk](http://www.htcarchitects.co.uk)  
E: [info@htcarchitects.co.uk](mailto:info@htcarchitects.co.uk)

client  
Lidl GB Ltd



project  
Briton Ferry

drawing title  
Existing Site Location  
Plan

date December 2021

status Planning

scale 1:1250 @ A4

drawn DS checked LS

job no. 2782 dwg no. P415 Rev. /