

THIS DRAWING IS COPYRIGHT, AND REMAINS THE PROPERTY OF HTC ARCHITECTS. IT MUST NOT BE REPRODUCED, USED, DISCLOSED OR TRANSMITTED TO THIRD PARTIES IN ANY FORM, IN WHOLE OR IN PART, WITHOUT PRIOR WRITTEN PERMISSION.

DO NOT SCALE!
ALL DIMENSIONS SHOULD BE CHECKED ON SITE BEFORE WORK COMMENCES

BASED ON BOYES REES ARCHITECTS PDF DRAWING: 6020-BRA-012000 LIDL NEATH BRITON FERRY SITE PLAN OPTION B REV5 DATED NOVEMBER 2017

BASED ON CORSCADDEN ASSOCIATES DRAWING: CA BF 2022-02 rev A DATED DECEMBER 2021

- SOFT LANDSCAPING KEY:**
- EXISTING TREES TO BE RETAINED
 - ROOT PROTECTION AREAS
 - EXISTING TREES TO BE REMOVED
 - EXISTING HEDGE TO BE RETAINED
 - EXISTING HEDGE TO BE REMOVED

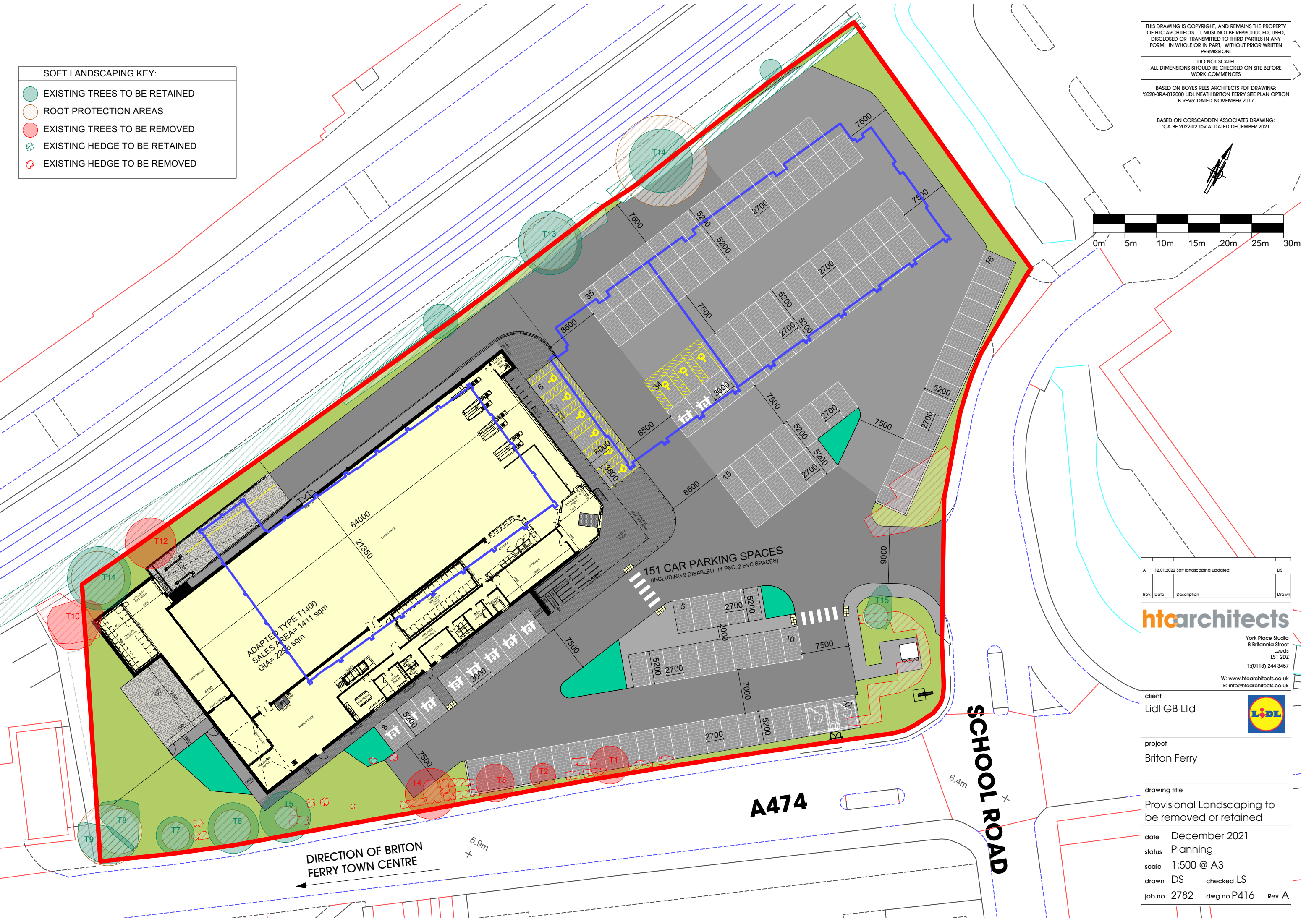
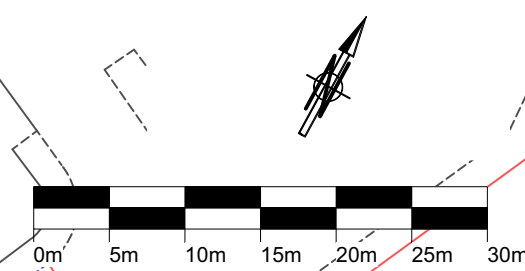

Rev.	Date	Description	Drawn
A	12.01.2022	Soft landscaping updated	DS

htcarchitects
 York Place Studio
 8 Britannia Street
 Leeds
 LS1 2DZ
 T: (0113) 244 3457
 W: www.htcarchitects.co.uk
 E: info@htcarchitects.co.uk

client
 Lidl GB Ltd



project
 Briton Ferry

drawing title
 Provisional Landscaping to be removed or retained

date December 2021
 status Planning
 scale 1:500 @ A3
 drawn DS checked LS
 job no. 2782 dwg no. P416 Rev. A