

HEAVY STANDARD TREE PIT DETAIL 1:50

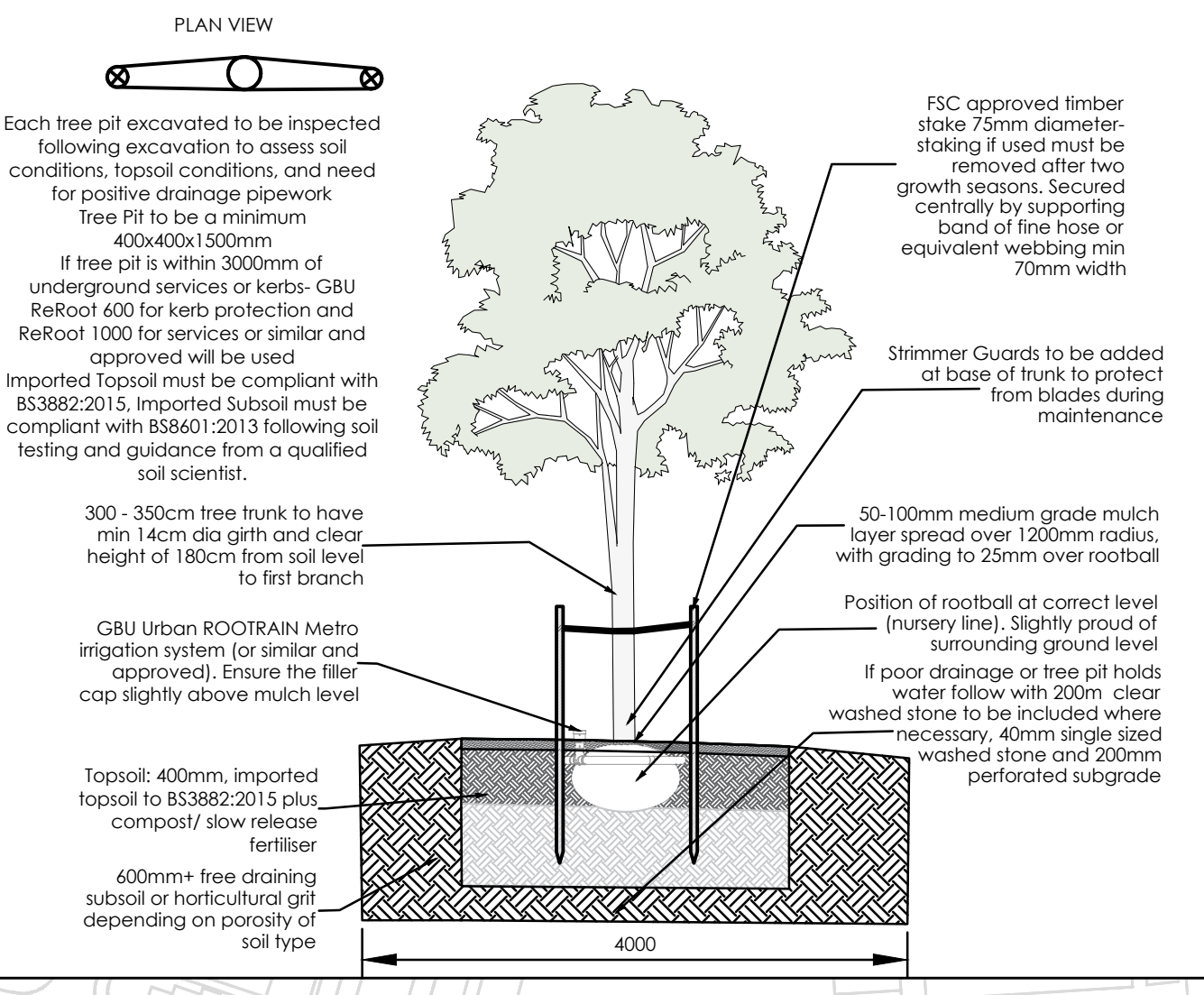

ADVANCED NURSERY STOCK TREE PIT DETAIL 1:50

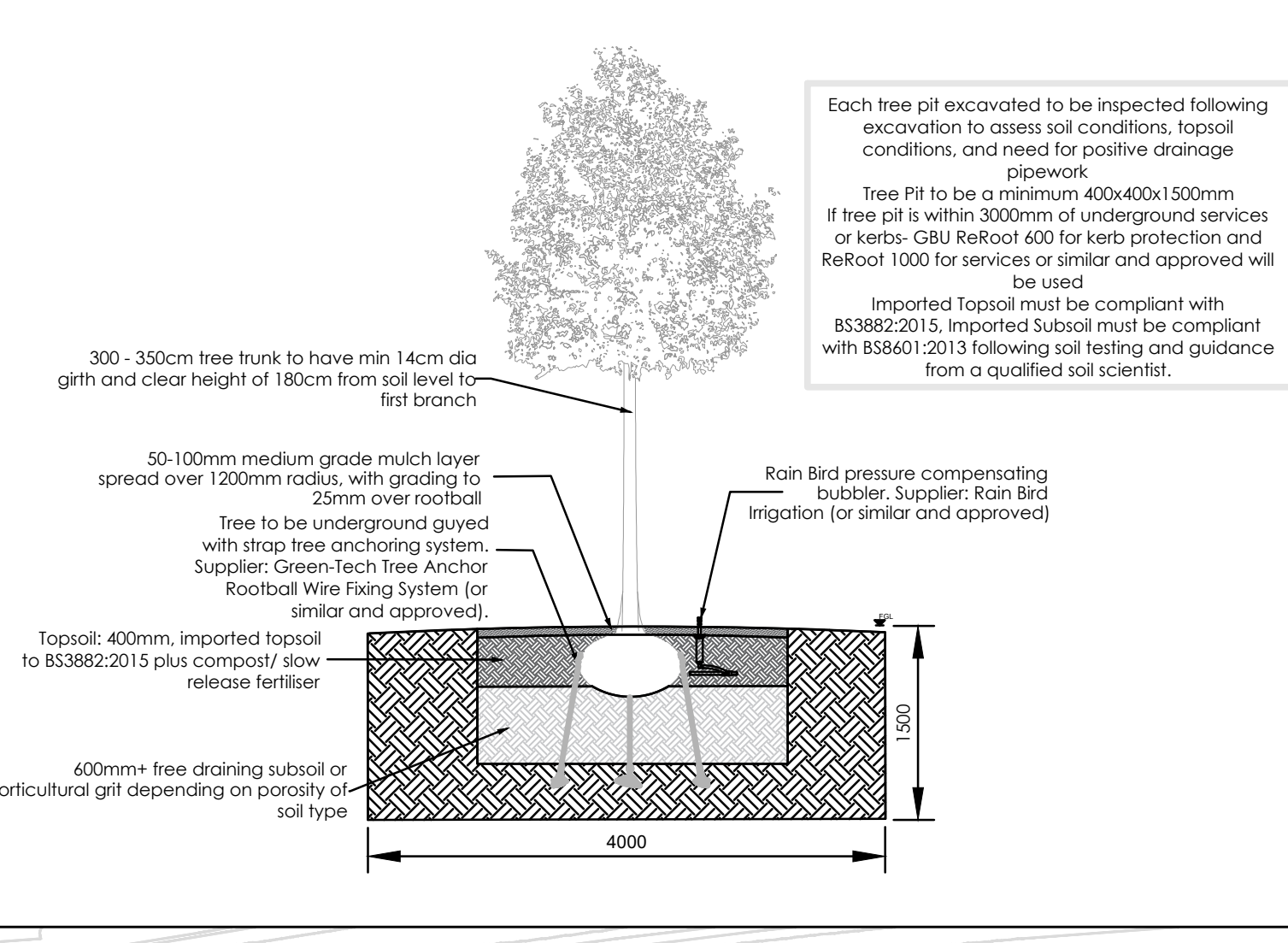

LANDSCAPE SPECIFICATIONS
GENERIC NOTES

- The contractor must ascertain for themselves the exact location of any underground services prior to excavations. Root barriers (to engineers details) shall be installed adjacent to any underground services and between trees and adjacent buildings or structures if the tree is within 10m.
- Please refer to the Project's Health and Safety documents/ RAMS for specific site risks.
- All works undertaken and materials should be completed in line with horticultural best practice and in accordance with relevant guidance and most current set out in British Standards at time of project installation. All landscape works should be undertaken by competent and trained personnel with relevant equipment and machinery accreditation.
- Where possible, all planting should be grown and sourced in the UK and supplied by a local nursery to the project, that has been approved by the Landscape Architect in advance of procurement and installation. All subsoils should be agreed upon with the client and the Landscape Architect prior to procurement and installation.
- All airings to be removed from the site at the contractor's expense unless noted otherwise.

RESPONSIBILITIES

- Unless otherwise agreed in writing, it will be the responsibility of the Client (or their appointed Site Agent, Manager or contractor) to ensure that all necessary health and safety arrangements and other legislation are complied with (including the identification and location of underground utilities prior to any excavation and the application of any herbicides).
- All staff must be adequately trained in the tasks they are undertaking and all appropriate risk assessments and method statements must be completed in advance. Appropriate insurance must be maintained by any contractor or sub-contractor.
- The main contractor and any sub-contractors are to be briefed by the Site Agent / Manager on the relevant sections of this prior to commencing any works.
- The Client (or their appointed Site Agent / Manager) is responsible for contacting the LPA at any time issues relating to the trees on site are raised.

GROWING MEDIAS AND SOIL DEPTHS

- If in situ topsoil is to be used then SRS and SRP Assessments must be carried out by trained personnel.
- All topsoil and subsoil used in planting areas must be in accordance with BS3882:2015, BS8545:2014, and BS8601:2013. Soil Analysis should be undertaken by a soil scientist prior to work.
- If imported soil is used, it should must be in accordance with BS3882:2015, BS8545:2014, and BS8601:2013 certified as such and analysed by an approved soil scientist prior to work. Samples should be delivered to site for CA approval.
- Topsoil heaps location and dimensions should be agreed with the manager and stored no deeper than 2 metres to retain aeration and dry properties prior to cultivation. Should the soil show signs of being anaerobic, works are to stop, soil heap is to be tested and heap is to be spread to allow for proper aeration and sample tested prior to works recommencing. Use of tracked machine for heap and protect heap from wet weather following works.
- Topsoil must not contain stones exceeding 35mm dimensions in any direction, soil to be taken picked prior to and post cultivation.
- Subsoil is required to make up levels (1000mm) in accordance with BS8601:2013, be free draining and clean.
- Ameliorants including all compost types, mulches and soil conditioners used in planting should be pest free.
- Any pesticides use (such as herbicides, insecticides, fungicides and slug pellets) should be discouraged due to their effect and harm to surrounding wildlife, as such any pesticides used should be strongly considered against potential harm and if used be non-residual.
- Planting beds should be properly cultivated to allow for proper aeration and prevent possible waterlogging, topsoil depth should vary depending on planting type (as follows):
 - Tree Planting to receive 400mm depth of approved topsoil (after light consolidation)
 - Shrub Planting to receive 400mm depth of approved topsoil (after light consolidation)
 - Turfed lawn areas to receive 150mm depth of approved topsoil (after light consolidation)
 - Hedge/rows to receive 450mm depth of approved topsoil (after light consolidation).

PLANTING NOTES

- Plant handling at the nursery and transit up to delivery, shall be in accordance with 'Plant Handling' the booklet is published by the Committee for Plant Supply and Establishment (CPSE). The contractor shall comply with clauses 3 & 4 of the above booklet (obtained from The Horticultural Trades Association which refers to the receipt, uprooting and temporary storage of plants).
- Plants shall be first class examples of their species or variety, free from all pests and diseases with good fibrous root systems and materially undamaged. Refer to relevant sections of BS3938:1-4 Specification of Nursery Stock.
- Tree planting must be compliant with BS8545 (table 1), compliance will be assessed post delivery and before planting.
- All planting is to be in general compliance with BS4428:1989 Code of Practice for General Landscape Operations. All trees should be staked or underground guided in accordance with tree size and soil conditions.

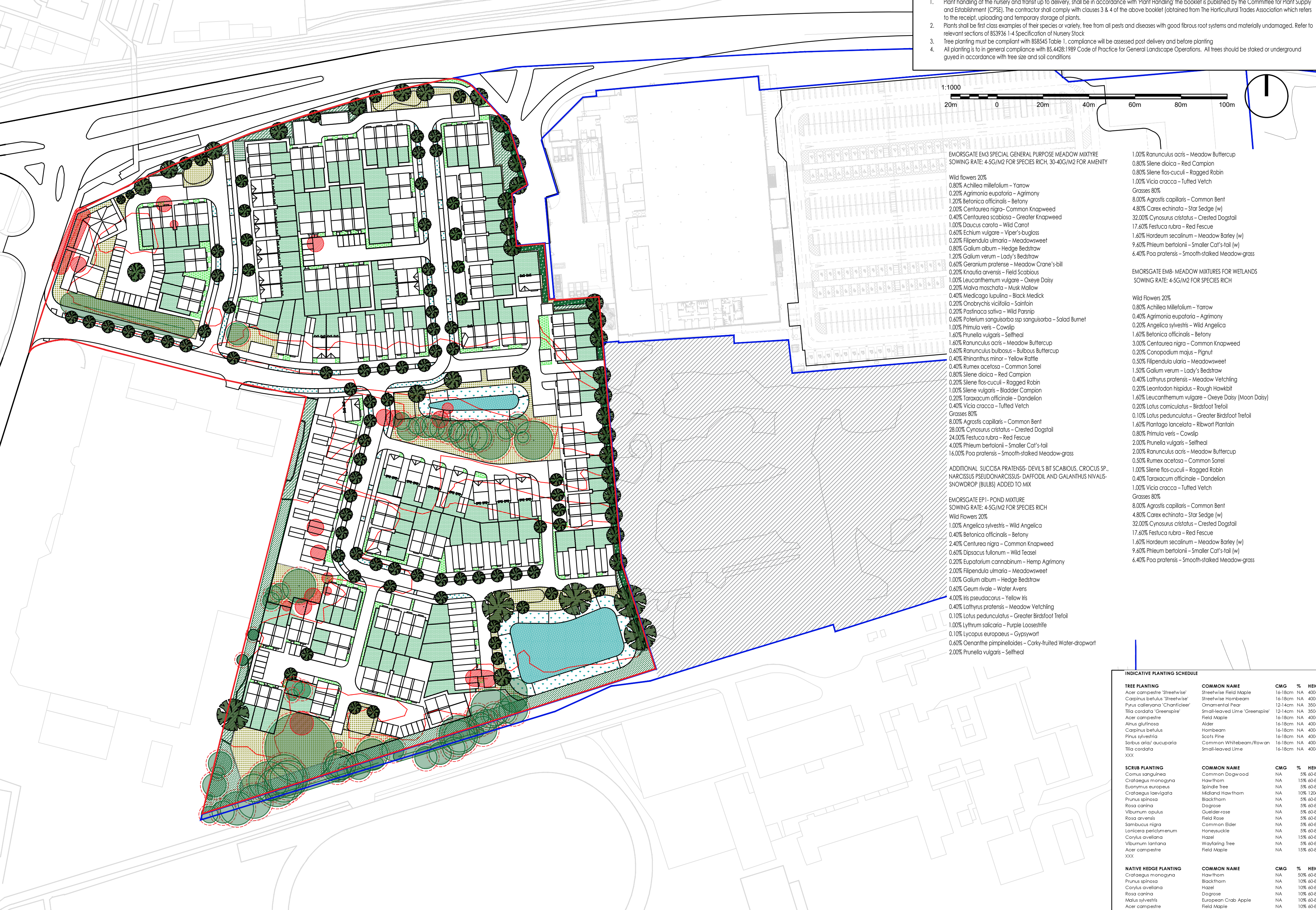

PLANTING NOTES (CONTINUED)

- Works must be carried out when soil and weather conditions are suitable. Do not plant during periods of frost or wind. Planting of bare root and rootball planting should only occur during the planting season, typically between late October to late March.
- All containerised planting can be planted at any time of the year, should ground and weather conditions permit.
- Works must be carried out when soil and weather conditions are suitable. Do not plant during periods of frost or wind. Planting of bare root and rootball planting should only occur during the planting season, typically between late October to late March.
- All containerised planting can be planted at any time of the year, should ground and weather conditions permit.
- Ensure that adequate watering is provided dependent on the plant type, soil type and weather conditions, with particular interest paid to the size of trees provided when determining suitable irrigation and airflow systems to be installed as specified.
- Initial irrigation should occur immediately after planting with watering directly onto the rootball being the preferred method rather than around it. Consideration should be paid to the size of a tree to determine the amount and frequency of tree watering during the first year of life.
- Ensure that adequate watering is provided dependent on the plant type, soil type and weather conditions, with particular interest paid to the size of trees provided when determining suitable irrigation and airflow systems to be installed as specified.
- Ensure that adequate watering is provided dependent on the plant type, soil type and weather conditions, with particular interest paid to the size of trees provided when determining suitable irrigation and airflow systems to be installed as specified.
- Ensure that adequate watering is provided dependent on the plant type, soil type and weather conditions, with particular interest paid to the size of trees provided when determining suitable irrigation and airflow systems to be installed as specified.
- Ensure that adequate watering is provided dependent on the plant type, soil type and weather conditions, with particular interest paid to the size of trees provided when determining suitable irrigation and airflow systems to be installed as specified.

TREE PLANTING

- All trees should be provided with adequate rooting volume and spacing for future root and canopy growth. Where possible this should be done through natural soil conditions (e.g. veges) and planting within soil and canopy growth.
- All trees should be provided with adequate rooting volume and spacing for future root and canopy growth. Where possible this should be done through natural soil conditions (e.g. veges) and planting within soil and canopy growth.
- All trees should be provided with adequate rooting volume and spacing for future root and canopy growth. Where possible this should be done through natural soil conditions (e.g. veges) and planting within soil and canopy growth.
- All trees should be provided with adequate rooting volume and spacing for future root and canopy growth. Where possible this should be done through natural soil conditions (e.g. veges) and planting within soil and canopy growth.
- All trees should be provided with adequate rooting volume and spacing for future root and canopy growth. Where possible this should be done through natural soil conditions (e.g. veges) and planting within soil and canopy growth.

WILDLIFE AREAS

- No topsoil is required within wildlife seeding areas. Seed should be sown into good quality, clay free subsoil. Cultivate to 150mm depth and all weeds, stones, and deleterious material larger than 35mm in any direction shall be removed. Cultivate seed bed that is rolled and raked to produce a firm 25mm deep. Allow germination to the existing seed bank. After 2-3 weeks spray regrowth with an approved selective herbicide. Allow to die back and rake off.
- Lightly water and seed late August or September or April to May, at seeding to be sown of supplier's recommendations.
- First cut shall be August to September and lightly the following spring using a flail mower or strimmer. All cuttings to be rolled up and disposed of off site.
- Subsequent cuts upon completion of flowering in October with flail or strimmer with string removed.

IMPLEMENTATION AND MAINTENANCE

- Aftercare maintenance will be required for a 12 month period. Maintenance includes weed control, litter picking and watering as required.
- Any tree or shrub planting that dies, is diseased, damaged or poorly developed shall be replaced at the end of the 12 months maintenance and defects period during the next appropriate planting season (with same sized specimens). Any planting that is found to be missing or incorrect will be rectified and justification given for this, any substitution should be approved by CA, Project Horticulturist or Landscape Architect prior to replacement or replanting. All maintenance operations should conform with BS7332:1993 Part 4: Recommendations for Maintenance (except amenity turf).
- All planting works should conform with BS4428:1989 Code of Practice for General Landscape Operations (excluding hard landscape operations).
- The Landscape Architect will oversee the implementation on a weekly basis, or as required, and maintenance on a monthly basis as agreed with client and landscape contractor.
- The Landscape Architect will inspect trees for compliance with BS8545 table 1 p.21 and supply, planting and aftercare in accordance with BS8545.
- The Landscape Architect shall provide a design implementation certificate to show compliance once planting is completed.
- Unless otherwise agreed all planting to be undertaken in the first available planting season following adjacent hard landscape building.

AFTERCARE

- Trees, shrubs and hedges should be inspected upon completion if the development and any post development works specified to be BS3998:2010.
- Inspect trees and shrubs during periods of drought (to ensure proper irrigation) and following strong winds or frozen conditions, and firm-in where necessary.
- Much is to be replanted to original depth (50-100mm) at least annually keeping the stem base clear of material.
- Once planted all areas must be kept adequately watered and weed and litter free at all times.
- Continued irrigation should be undertaken as required based upon the weather conditions, soil moisture levels and the response of the planted species to water deficits (e.g. drought) or periods of prolonged saturation.
- Replacement planting (especially failed hedging plants) should be undertaken during the subsequent planting season if necessary.
- Any trees or planting that dies, is diseased, damaged or poorly developed within a period of 5 years from the completion of the development, shall be replaced in the next planting season with others of similar size and species.

ROOTBALL WRAPPING

- Natural Hessian (if unfurled biodegradable), can be left in place to break down over time. It should be loosened and cut away from the top and sides of the rootball to prevent root girdling.
- Any jute or biodegradable wire should be cut away from the top of the rootball and trunk to prevent strangulation as the tree grows.
- If treated or synthetic hessian, it should be removed completely to avoid restricting root growth.
- Plastic or non-biodegradable materials must be completely removed before planting.

ROOTBARRIERS

- Linear root barriers are to be installed in locations confirmed by the project engineers to protect services and surface treatments as required. Root barriers shall be installed adjacent to any underground services and between trees and adjacent buildings or structures if trees are within 10m from them.
- Root barriers should be a minimum of 1.2m from the trunk and as close to the surface as possible.
- Linear root barriers should be installed to manufacturers guidance, with a recommended minimum of 600mm depth when adjacent to surface treatments. If root barriers are required to protect services or below ground offention, the root barrier is recommended to extend 300mm lower than services, with specific requirements being coordinated with engineer's drawings.

MULCHING AND WEED CONTROL

- All planting areas (trees, shrubs and hedges) to be mulched with medium grade bark chipp to depth of 50mm to 100mm.
- Areas around the base of new plantings to be free from complete vegetation preferably by hand weeding or use of mulch. If herbicides are to be used to control competing vegetation then they must be carefully selected and applied in accordance with the product label and any legislative controls (including operator use) in order to avoid environmental contamination or damage to trees.
- Avoid mulching altogether where newly planted trees can be managed by hand weeding (not stinging or chemical application) and the soil is well structured and resistant to staking damage.
- Avoid applying mulch over the rootball surface (typically approximately 20cm from the stem) though a thin skim of 25mm is acceptable particularly where the soil may be protected from staking damage or rapid stem flow damage where smooth barked trees are planted.
- Aim for a radial application of 1.20m, increasing this as appropriate for very large trees beyond the rootball. Much depths may increase up to a maximum of 75mm but typically 50mm increase much extent in whatever direction is available if the planting site is constrained.
- Finer textured mulches including well-sorted composts may be used on fine-textured sandy soils, so long as they are free draining and so long as the mulch is worked gently into the surface soil horizon (keyed in) rather than sitting on the soil surface where it may form an interface with underlying soil.
- Ensure that aeration and irrigation inlet cases sit above the mulch and feature a filter to prevent clogging where fine textured mulch is used.
- Never use geotextiles, weed membranes or similar when applying mulch circles.
- Maintain mulch circles for 3 years (or more if establishment is slow) but remove mulch circles if they are causing harm (e.g. impeding water and air movement) and consider alternative management.

PLANTING SHRUBS AND HEDGES

- Planting Shrubs: To receive a minimum of 400mm depth of approved topsoil. Shrubs are to be planted in prepared beds which have been backfilled and firmed up to the nursery level.
- Bareroot Shrub planting is to be planted during dormant season between November and March. However planting should be avoided if the ground is frozen. Shrub planting that is herbaceous/perennial container grown should be planted in Spring (March to May) or Autumn (September to October) avoiding mid-summer planting due to the soil drying too quickly.
- Where planting is a capsule to building or wall, a minimum of 300mm border gutter chip should be placed to enable maintenance access and prevent planting damaging footings.
- Planting Hedges: Formal hedges are to be planted in double or triple staggered rows (unless otherwise specified) alongside the installation of a central fence post and 3 wire fence to aid establishment, unless additional boundary treatment has been specified.
- Rabbit proof fencing, spiral cones or tree guards may be required to aid the establishment of planting and protect from mammals.

TURFING

- Turf to be laid over a minimum of 150mm depth of lightly consolidated approved topsoil.
- No turf shall be laid in frost or exceptionally dry weather. Turfing should occur in April to May or September to October, subject to suitable weather conditions.
- The wellbeing of the turf shall be the contractors responsibility prior to PC and for the duration of the maintenance period. Any failures shall be replaced at the Contractors expense.
- Turf shall be grown by a member of the Turfgrass Growers Association (TGA). Certification of its provenance shall be supplied to the CA.
- Prior to the installation of the topsoil, subsoil shall be rotavated. Lightly cultivate the topsoil, harrow and rake topsoil into a fine fluff suitable for final grading prior to turfing. Rate to a hue, even consolidated surface.
- Turf shall be laid within 36 hours of delivery and immediately watered after laying. Bumps, ridges and depressions will not be accepted.

KEY

- Applicant Site Boundary
- Applicant Ownership Boundary
- Adjacent Parcel or Scheme
- Soft Landscape
- Existing tree planting to be retained, to be read in conjunction with associated indicative planning schedule
- Existing tree planting to be removed, to be read in accordance with Arboricultural report (61417_REF_BS5837_P1)
- Existing vegetation to be retained and enhanced. Future Management to be agreed as part of technical design.
- Existing vegetation to be removed.
- Proposed Tree Planting, to be read in conjunction with associated indicative planning schedule
- Proposed native hedge planting, to be read in conjunction with associated indicative planning schedule
- Proposed native scrub mix planting to enhance boundary vegetation / landscape buffers. To be read in conjunction with associated indicative planning schedule
- Proposed seasonally wet planting to SuDS features. To be seeded with suitable native wildflower / grass mix to tolerate dry and wet conditions. Emorgate EP1 Pond Edge Mixture (or similar and approved)
- Proposed locally sourced wildflower and grassland verge mix. Emorgate EMB Special Purpose Meadow Mixture with additional Succisa pratensis seedling (or similar and approved).
- Proposed locally sourced grass verge mix. Raindown Medallion Lawn Seed (or similar and approved).
- Proposed turf to rear gardens (or similar and approved).
- Proposed locally sourced rain garden mix (or similar and approved).
- Proposed retention basin to form part of sustainable drainage systems - to be seeded with suitable native wildflower / grass mix to tolerate dry and wet conditions. Emorgate EMB Meadow Mixture for Wetlands (or similar and approved).

NOTES:

- DO NOT SCALE ANY ITEMS OR INFORMATION FROM THIS DRAWING.

P3	S3	29/01/2026	LAYOUT_AMENDMENT	GT	SN
P2	S3	27/01/2026	LAYOUT_AMENDMENT	GT	SN
P1	S0	14/10/2025	FIRST_DRAFT	GT	SN
Vers.	Suit.	Date	Description	Drawn	Chk.
F1-FINAL					
CARNEY_SWEENEY TALBOT_GREEN					
4th Floor, James William House, 9 Museum Pl, Cardiff CF10 3BD					
GENERAL_ARRANGEMENT_PLAN					
Scale @ A1: 1:1000@A1					
Dwg No: 61417_DWG_PROJECTPLAN					
Rev P3					